

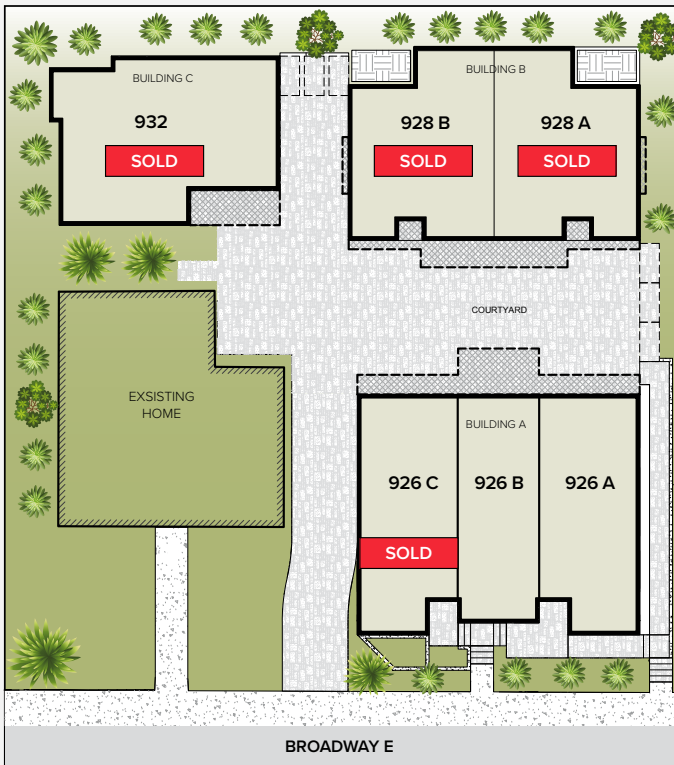

# ELEMENT 2

926 - 930 BROADWAY E, SEATTLE, WA 98102

**PRIVATE ROOFTOP DECKS!  
WALK SCORE 90**



## CITY INSPIRED LIVING ON CAPITOL HILL!

Element 2, located on a quiet street in the historic Harvard Belmont District. Inside each home you'll find opulent living spaces filled with luxury appliances, statement lighting, floor to ceiling windows, large kitchens, spacious islands, & private rooftop decks offering spectacular sunset views. Located just blocks away from countless restaurants, shops, parks and a bustling nightlife.

ADDRESS	APPROX SQ FT	BD/BA	EXTRAS	STATUS
926A	1490	2/2.25	open concept, rooftop deck, 1 car garage	COMING SOON!
926B	1399	2/1.75	open concept, rooftop deck	COMING SOON!
926C	1490	2/2.25	open concept, rooftop deck, 1 car garage	SOLD
928A	1795	3/3.25	open concept, rooftop deck, 1 car garage	SOLD
928B	1795	3/3.25	open concept, rooftop deck, 1 car garage	SOLD
932	2404	3/3.5	open concept, rooftop deck, 1 car garage	SOLD

FOR MORE INFORMATION CONTACT  
**CHRISTINE HOLCOMB**

206.673.3409 | Director of Sales

Windermere **VAN WYCK & PORTER** REAL ESTATE

