

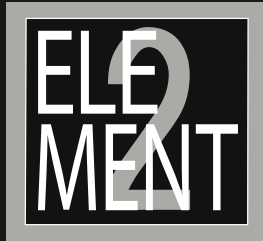

ELEMENT 2

926 - 930 BROADWAY E, SEATTLE, WA 98102

PRIVATE ROOFTOP DECKS!
WALK SCORE 90



CITY INSPIRED LIVING ON CAPITOL HILL!

Element 2, located on a quiet street in the historic Harvard Belmont District. Inside each home you'll find opulent living spaces filled with luxury appliances, statement lighting, floor to ceiling windows, large kitchens, spacious islands, & private rooftop decks offering spectacular sunset views. Located just blocks away from countless restaurants, shops, parks and a bustling nightlife.

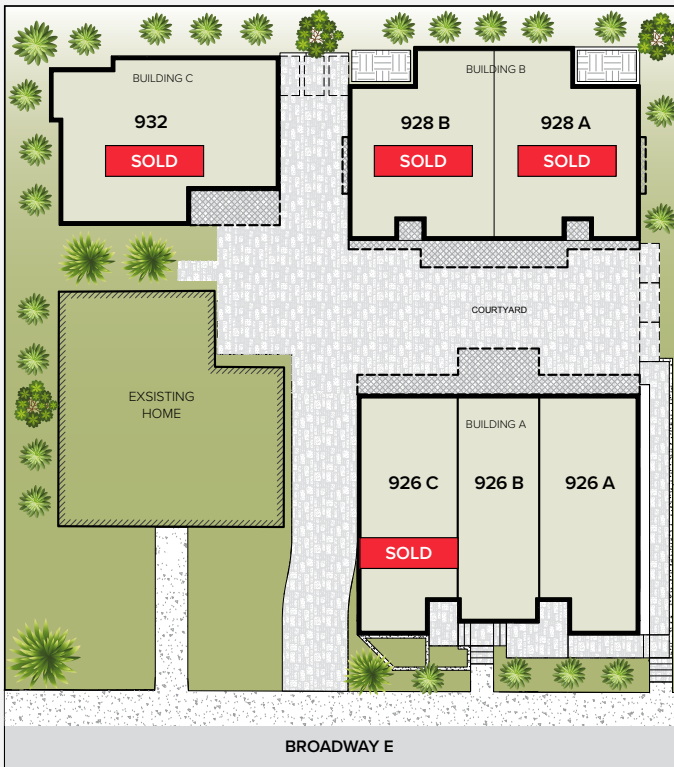

ADDRESS	APPROX SQ FT	BD/BA	EXTRAS	STATUS
926A	1528	2/2.25	open concept, rooftop deck, 1 car garage	COMING SOON!
926B	1432	2/1.75	open concept, rooftop deck	COMING SOON!
926C	1527	2/2.25	open concept, rooftop deck, 1 car garage	SOLD
928A	1792	3/3.25	open concept, rooftop deck, 1 car garage	SOLD
928B	1788	3/3.25	open concept, rooftop deck, 1 car garage	SOLD
932	2364	3/3.5	open concept, rooftop deck, 1 car garage	SOLD

FOR MORE INFORMATION CONTACT
CHRISTINE HOLCOMB

206.965.9686 | Director of Sales

Windermere REAL ESTATE VAN WYCK & PORTER | REAL ESTATE

