



## CITY INSPIRED LIVING ON CAPITOL HILL!

Element 2, located on a quiet street in the historic Harvard Belmont District. Inside each home you'll find opulent living spaces filled with luxury appliances, statement lighting, floor to ceiling windows, large kitchens, spacious islands, luxurious master suites, & private rooftop decks offering spectacular sunset views. Located just blocks away from countless restaurants, shops, parks and a bustling nightlife.

## ELEMENT 2

926 - 930 BROADWAY E, SEATTLE, WA 98102

PRIVATE ROOFTOP DECKS!  
WALK SCORE 90

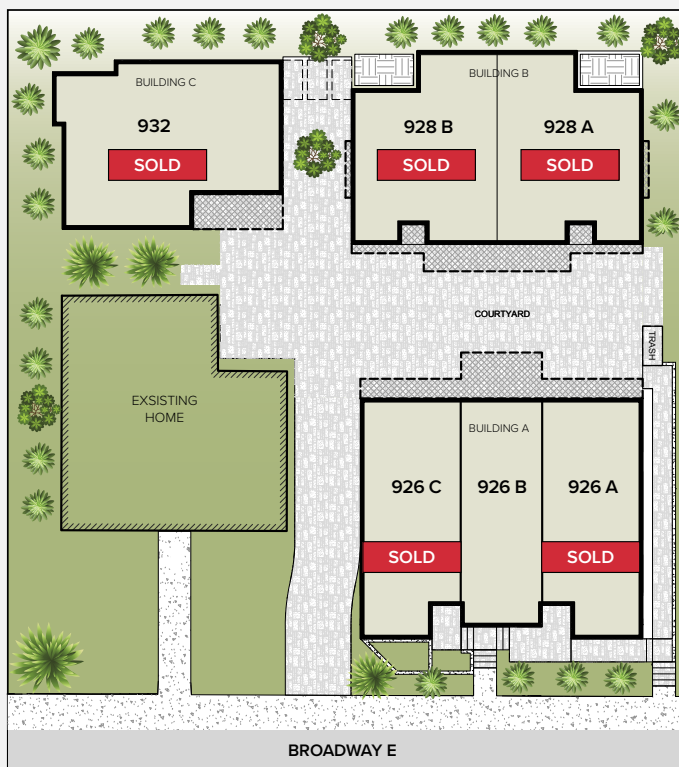

ADDRESS	APPROX SQ FT	BD/BA	EXTRAS	STATUS
926A	1528	2/2.25	open concept, rooftop deck, 1 car garage	<b>SOLD</b>
926B	1432	2/1.75	open concept, rooftop deck	<b>\$1,079,900</b>
926C	1527	2/2.25	open concept, rooftop deck, 1 car garage	<b>SOLD</b>
928A	1792	3/3.25	open concept, rooftop deck, 1 car garage	<b>SOLD</b>
928B	1788	3/3.25	open concept, rooftop deck, 1 car garage	<b>SOLD</b>
932	2364	3/3.5	open concept, rooftop deck, 1 car garage	<b>SOLD</b>

FOR MORE INFORMATION CONTACT  
**CHRISTINE HOLCOMB**

206.965.9686 | Director of Sales

Windermere **VAN WYCK & PORTER** REAL ESTATE

