



## CITY INSPIRED LIVING ON CAPITOL HILL!

Element 2, located on a quiet street in the historic Harvard Belmont District. Inside each home you'll find opulent living spaces filled with luxury appliances, statement lighting, floor to ceiling windows, large kitchens, spacious islands, & private rooftop decks offering spectacular sunset views. Located just blocks away from countless restaurants, shops, parks and a bustling nightlife.

## ELEMENT 2

926 - 930 BROADWAY E, SEATTLE, WA 98102

PRIVATE ROOFTOP DECKS!  
WALK SCORE 90

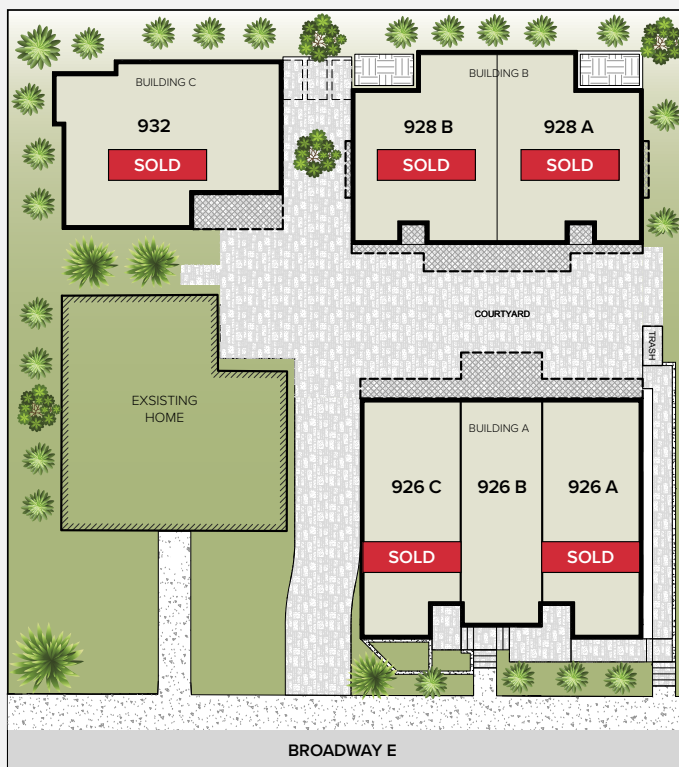

ADDRESS	APPROX SQ FT	BD/BA	EXTRAS	STATUS
926A	1528	2/2.25	open concept, rooftop deck, 1 car garage	<b>SOLD</b>
926B	1432	2/1.75	open concept, rooftop deck	<b>\$959,900</b>
926C	1527	2/2.25	open concept, rooftop deck, 1 car garage	<b>SOLD</b>
928A	1792	3/3.25	open concept, rooftop deck, 1 car garage	<b>SOLD</b>
928B	1788	3/3.25	open concept, rooftop deck, 1 car garage	<b>SOLD</b>
932	2364	3/3.5	open concept, rooftop deck, 1 car garage	<b>SOLD</b>

FOR MORE INFORMATION CONTACT

**VAN WYCK & PORTER TEAM**

206.965.9686



VAN WYCK & PORTER | REAL ESTATE



SHELTERHOMESSEATTLE.COM

206.486.9209 | info@shelterhs.com | 10/13/2022